

East Quay Residency Pod – Visual Descriptions

This document includes visual descriptions of the East Quay residency pod and associated spaces.

Accessible Bathroom



A modern accessible bathroom with dark navy-blue tiled walls and bright yellow accessibility rails throughout. Yellow grab bars surround the toilet area and continue across the walls and ceiling for additional support. A square white sink sits beneath a softly glowing illuminated mirror. A large yellow heated towel rail is mounted on the right wall. The space has strong colour contrast between the dark tiles and yellow fittings, which may support visibility and navigation. The room is brightly lit with a clean, contemporary design.

View of East Quay from harbour



A wide exterior photograph of the East Quay arts complex beside a marina. Boats float in calm water in the foreground, reflecting the evening sunlight. The buildings are contemporary and sculptural, made up of geometric forms in white, red and natural concrete tones that look like shipping containers. Trees rise behind the complex, and the overall atmosphere feels open, coastal and architecturally distinctive.

Exhibition space exterior



An exterior photograph showing a modern building labelled 'Studio 10'. A white arrow points towards a striped red-and-white upper structure extending outward from the main building. Behind it sits a hillside town with trees and houses under dramatic dark clouds. The studio appears elevated above the surrounding area and integrated into the larger East Quay complex.

Studio 10 Exhibition Space Interior



A simple rectangular gallery space with plywood flooring and wood-paneled walls. Artworks and sculptural pieces are displayed around the room, with a long wooden bench positioned in the centre. Track lighting illuminates the space evenly from above. A window and glass door at the far end look out onto greenery. The room appears flexible and suitable for exhibitions.

Bedroom area



A compact sleeping nook built from pale plywood with engraved illustrated wall details inspired by plants and nature. A double bed is tucked into an alcove with soft bedding, patterned cushions and a dark blue geometric blanket. A curtain can be drawn across the sleeping area for privacy. The space feels cosy, enclosed and restful, with warm natural materials throughout.

Residential area view from window



A warm-toned interior space with large floor-to-ceiling windows overlooking the harbour town and coastline outside. Sunlight fills the room. Small potted plants sit along the wide window ledge, and two hanging pendant lights descend from the ceiling. Outside, a terrace walkway runs alongside the building. The atmosphere feels calm, airy and connected to the surrounding landscape.

Dining / Living Area



A view looking down into a bright dining area from the top of a red spiral staircase. A pale oval table sits beside large windows with built-in cushioned seating. Warm sunlight pours across the table and floor. Several small plants decorate the window ledge, and the space combines natural wood textures with soft yellow and red accents. The room feels welcoming, creative and full of natural light.

Annotated Floor Plan of Residency Pod

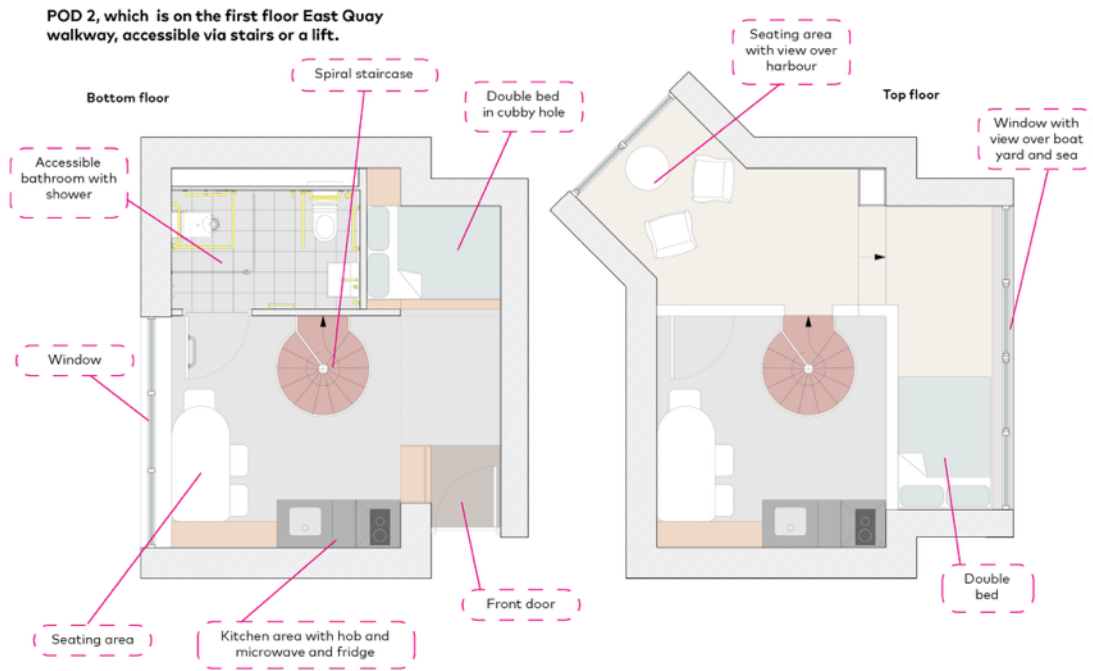

A simplified architectural floor plan showing the layout of Pod 2 at East Quay across two levels. The diagram includes labels identifying an accessible bathroom, kitchen area, seating areas, spiral staircase, sleeping spaces and windows with harbour views. The plan notes that the pod can be accessed by stairs or lift and suggests a compact but thoughtfully designed live/work environment.